**Legend**

- Proposed Pipe To Be Decommissioned In Place
- Laguna Atascosa National Wildlife Refuge
- Padre Island National Seashore
- Coastal Zone Boundary
- County Boundary



0 5 10
Miles



VALLEY PIPE LINES, INC.
VICINITY MAP

**Proposed Permit Modification
Decommissioning in Place
of 20" Pipeline and 10" Laterals
Padre Island
Kenedy, Kleberg & Willacy
Counties, Texas**



REV. 1

Date: 6/6/2023

Data Sources: TX RRC; Platts

c:\c1\hst\Louisiana Office Projects\167873 Energy Transfer-Houston Pipeline Company-Decomm of Panther Point PL\GIS

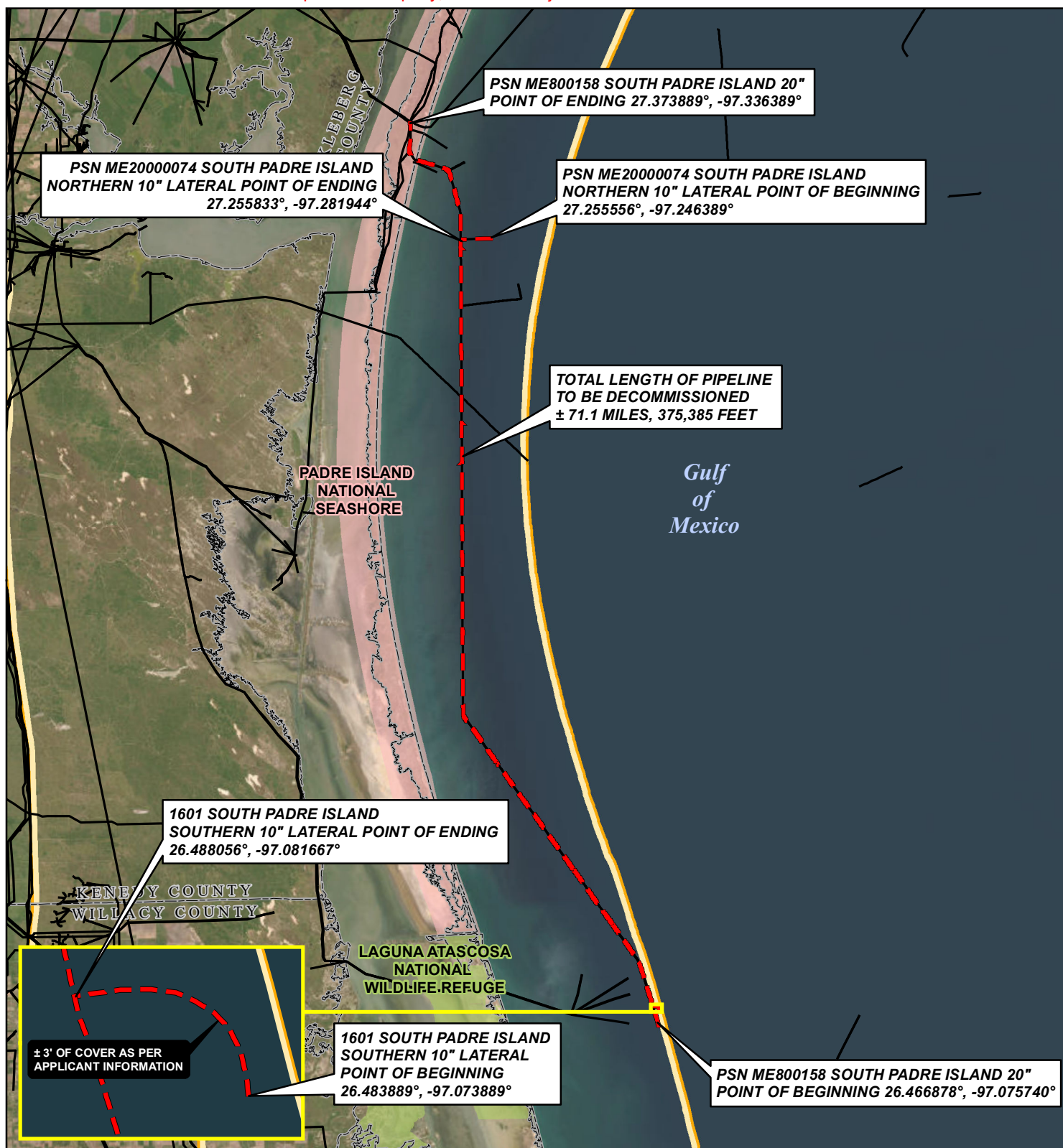
**Legend**

- Proposed Pipe to be Decommissioned In Place (71.1 miles)
- Existing Pipeline
- Laguna Atascosa National Wildlife Refuge
- Padre Island National Seashore
- Coastal Zone Boundary
- County Boundary

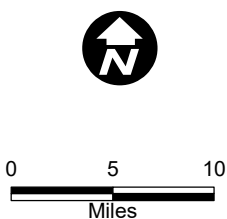

VALLEY PIPE LINES, INC.
AREA MAP

**Proposed Permit Modification
Decommissioning in Place
of 20" Pipeline and 10" Laterals
Padre Island
Kenedy, Kleberg & Willacy
Counties, Texas**



REV. 1

Date: 6/6/2023

Data Sources: TX RRC; Platts

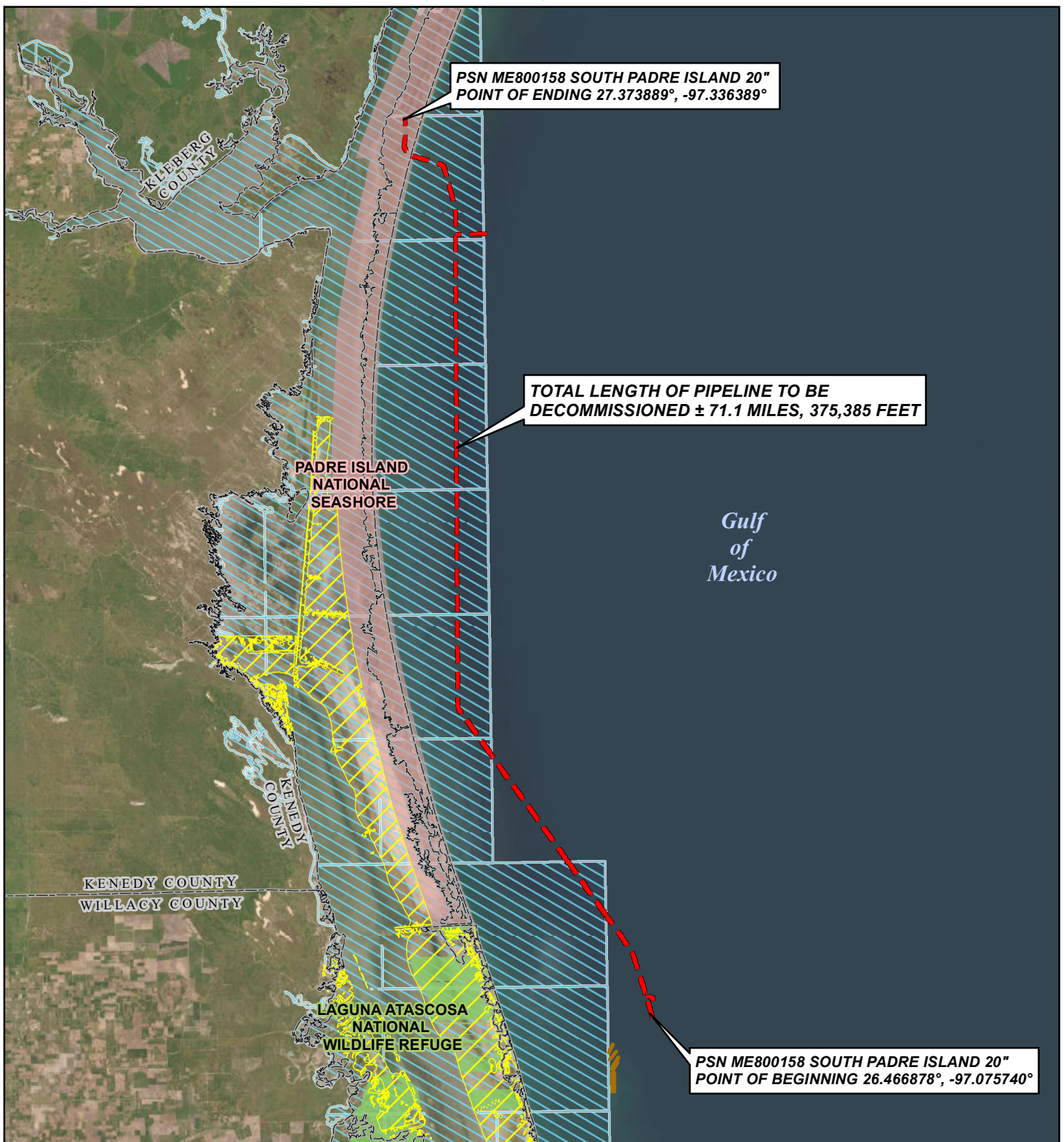

Legend

- Proposed Pipe to be Decommissioned In Place (71.1 miles)
- County Boundary
- Sand Source
- Laguna Atascosa National Wildlife Refuge
- Padre Island National Seashore
- State Threatened and Endangered Species Habitat
- USFWS Designated Critical Habitat
- Piping Plover - *Charadrius melodus*



0 5 10
Miles

VALLEY PIPE LINES, INC. THREATENED AND ENDANGERED SPECIES HABITAT MAP

**Proposed Permit Modification
Decommissioning in Place
of 20" Pipeline and 10" Laterals
Padre Island
Kenedy, Kleberg & Willacy
Counties, Texas**



REV. 1

Date: 6/6/2023

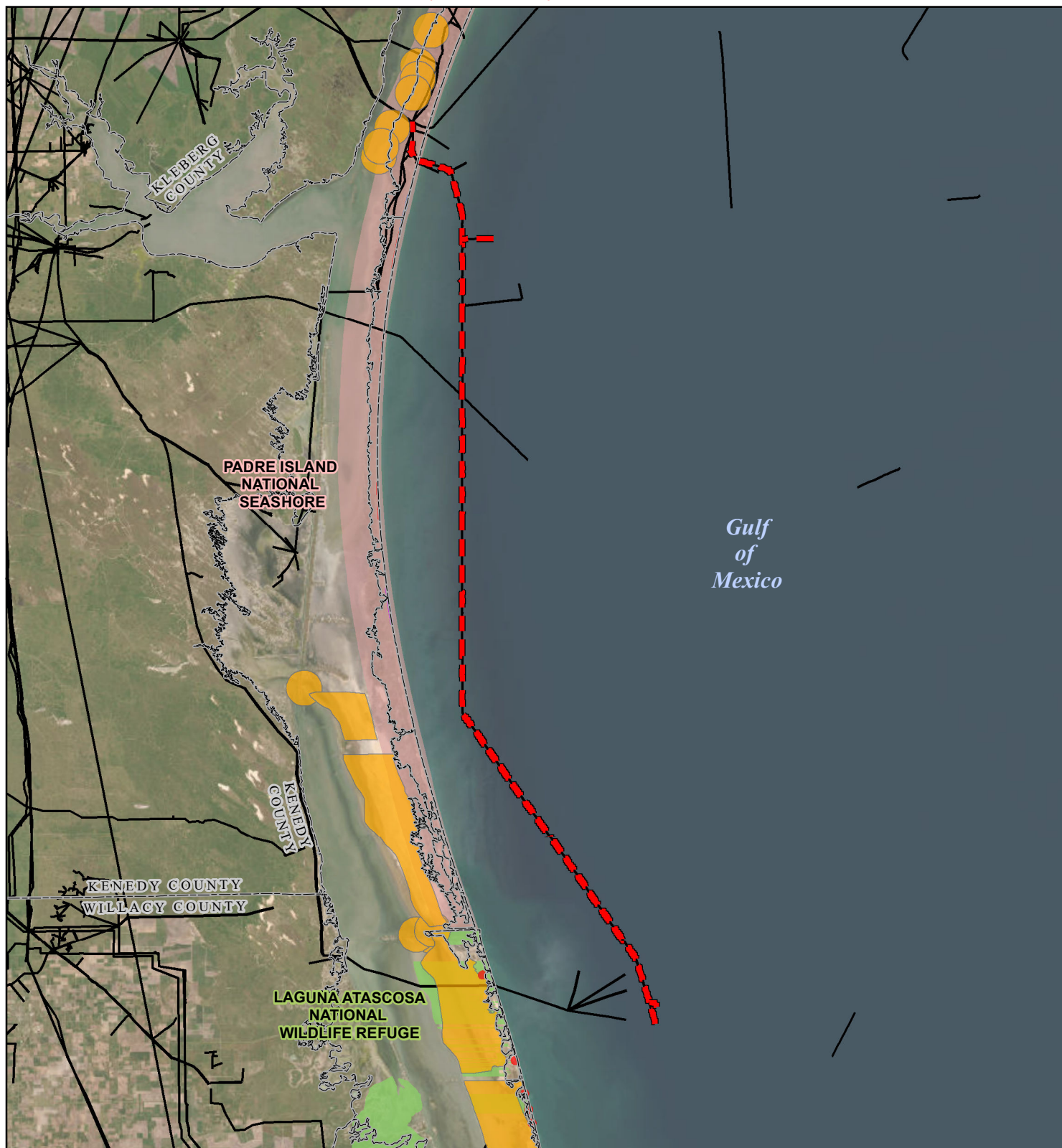

Legend

- | | |
|---|--|
| <p>Proposed Pipe To Be Decommissioned In Place (71.1 miles)</p> <p>Existing Pipeline</p> <p>County Boundary</p> <p>Laguna Atascosa National Wildlife Refuge</p> <p>Padre Island National Seashore</p> | <p>NDD EO Occurrence (T&E Listed)</p> <p>Kemp's Ridley sea turtle</p> <p>Green sea turtle</p> <p>Loggerhead sea turtle</p> <p>Piping plover</p> |
|---|--|



0 5 10
Miles

VALLEY PIPE LINES, INC.

NDD OCCURRENCES MAP

**Proposed Permit Modification
Decommissioning in Place
of 20" Pipeline and 10" Laterals
Padre Island
Kenedy, Kleberg & Willacy
Counties, Texas**



REV. 1

Date: 6/2/2023

Data Sources: TX RRC; Platts, TPWD

c:\c1\hst\Louisiana Office Projects\168220 Energy Transfer - Houston Pipeline - Decomm of Padre Island PL\GIS



Legend

- Access Road
- Proposed Pipe To Be Decommissioned In Place

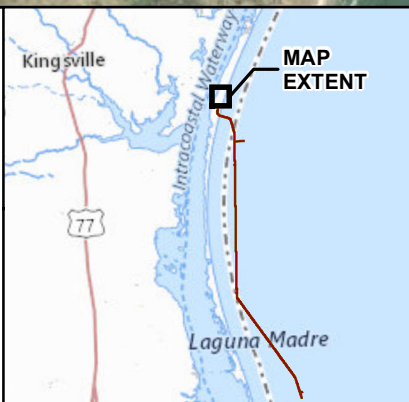
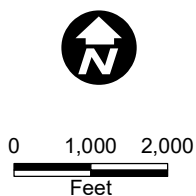

VALLEY PIPE LINES, INC.

PROPOSED ACCESS ROUTE

Proposed Permit Modification
Decommissioning in Place
of 20" Pipeline and 10" Laterals
Padre Island
Kenedy, Kleberg & Willacy
Counties, Texas



REV. 1

Date: 6/6/2023

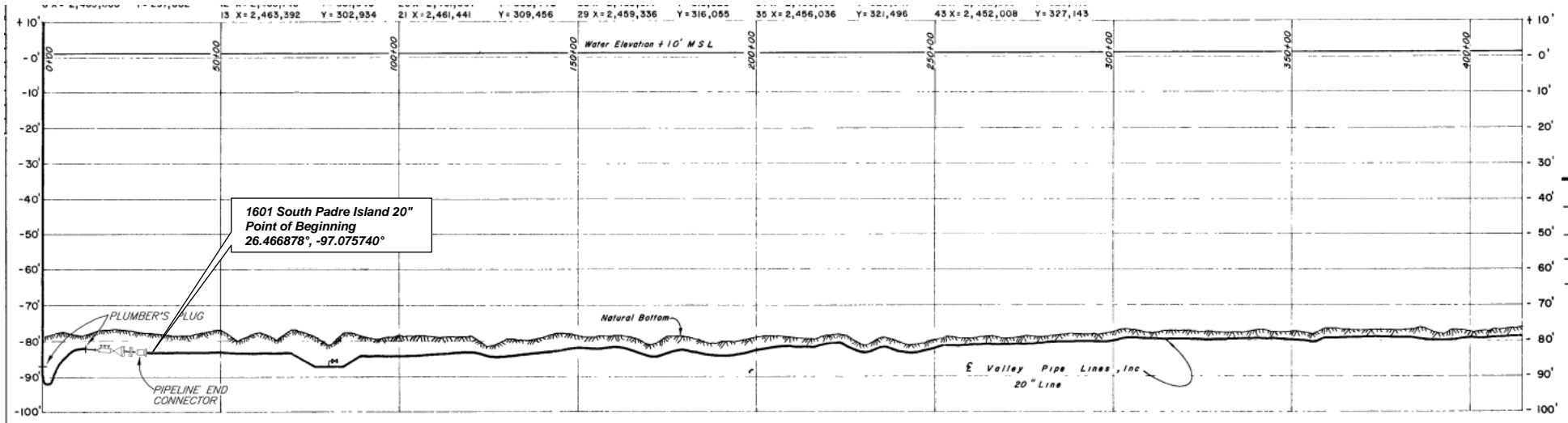

PROFILE

Scale 1" = 2000' Horizontal
1" = 20' Vertical

2 10/97 INSTALLED P/L END CONNECTOR & PLUMBERS LUG & ASBUILT PER M.O. 5/20/08 JC R/L SWP

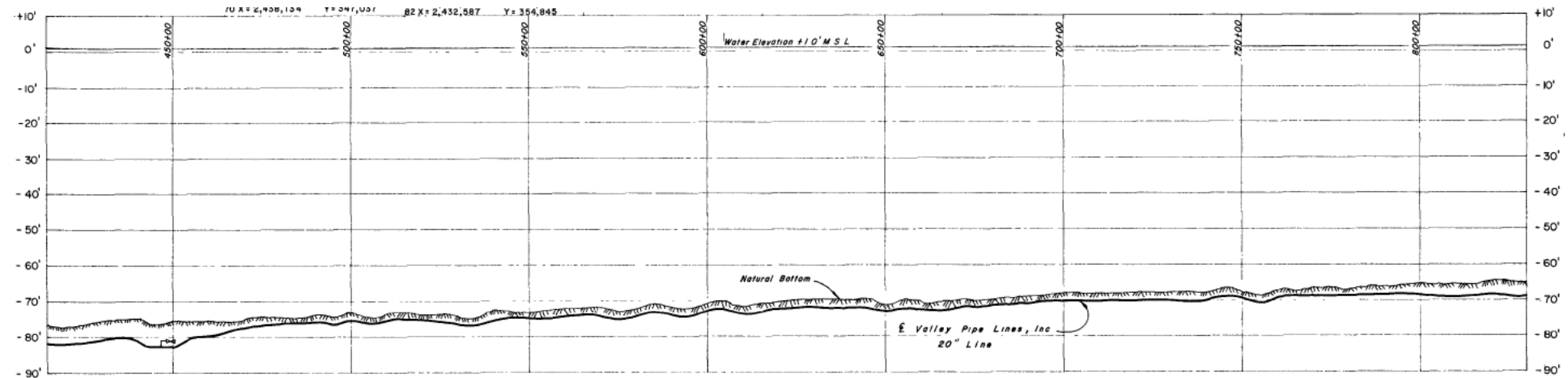

PROFILE

Scale 1" = 2000' Horizontal
1" = 20' Vertical

Legend

Proposed Pipe to be Decommissioned in Place

Total length of pipeline to be decommissioned is 71.1 miles.

Elevations at South Padre Island CG Station 8779748

Mean High Water (MHW)- 1.31'

Mean Low Water (MLW)- 0.14'

Mean Lower-Low Water (MLLW)- 0.00'

(Source: 1601 Engineering Drawings: HC-1601-10-V, from client). This drawing is a generalized depiction of the original data.

VALLEY PIPE LINES, INC.
PROJECT PROFILE - SHEET 1 of 5
Proposed Permit Modification
Decommissioning in Place
of 20" Pipeline and 10" Laterals
Padre Island
Kenedy, Kleberg & Wilacy
Counties, Texas

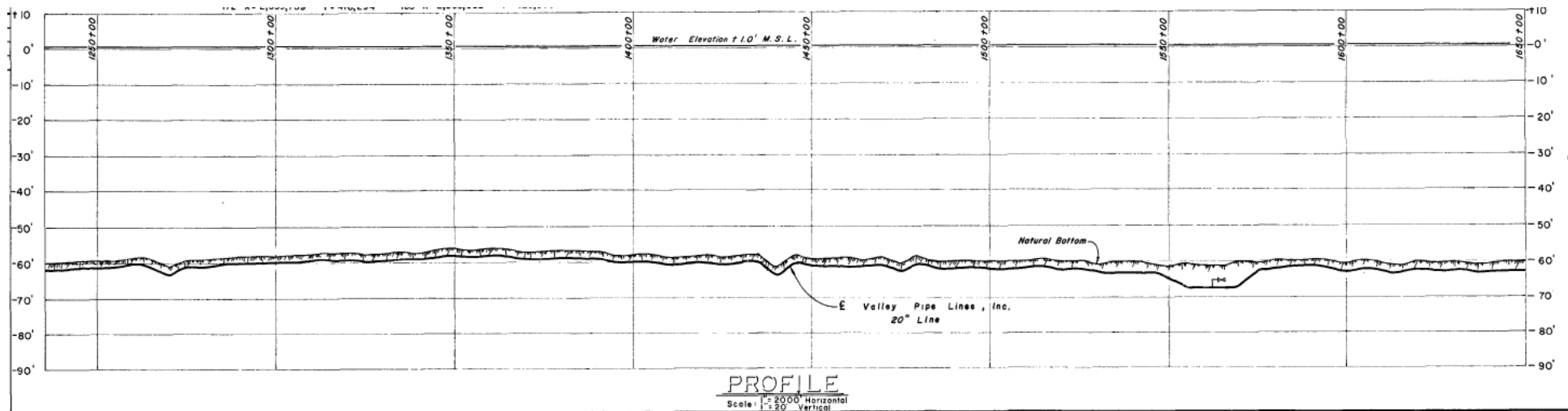
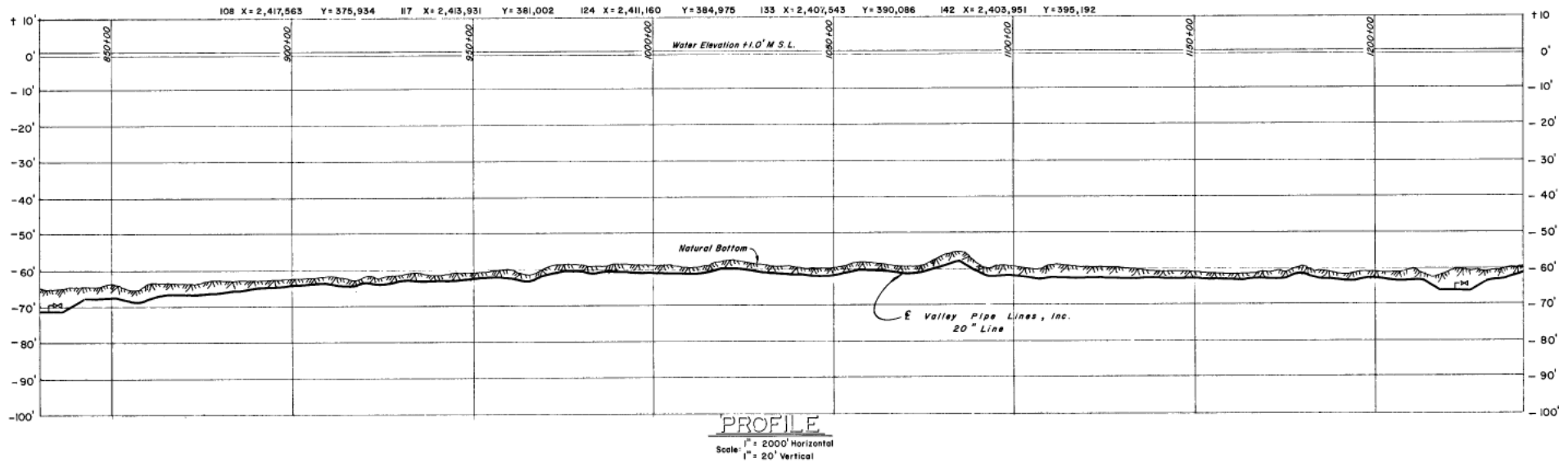

Date: 6/02/2023

**Legend**

— Proposed Pipe to be Decommissioned in Place

Total length of pipeline to be decommissioned is 71.1 miles.

Elevations at South Padre Island CG Station 8779748

Mean High Water (MHW)- 1.31'

Mean Low Water (MLW)- 0.14'

Mean Lower-Low Water (MLLW)- 0.00'

This drawing is a generalized depiction of the original data. (Source: 1601 Engineering Drawings: HC-1601-10-V, from client).

VALLEY PIPE LINES, INC.
PROJECT PROFILE - SHEET 2 of 5
Proposed Permit Modification
Decommissioning in Place
of 20" Pipeline and 10" Laterals
Padre Island
Kenedy, Kleberg & Wilacy
Counties, Texas

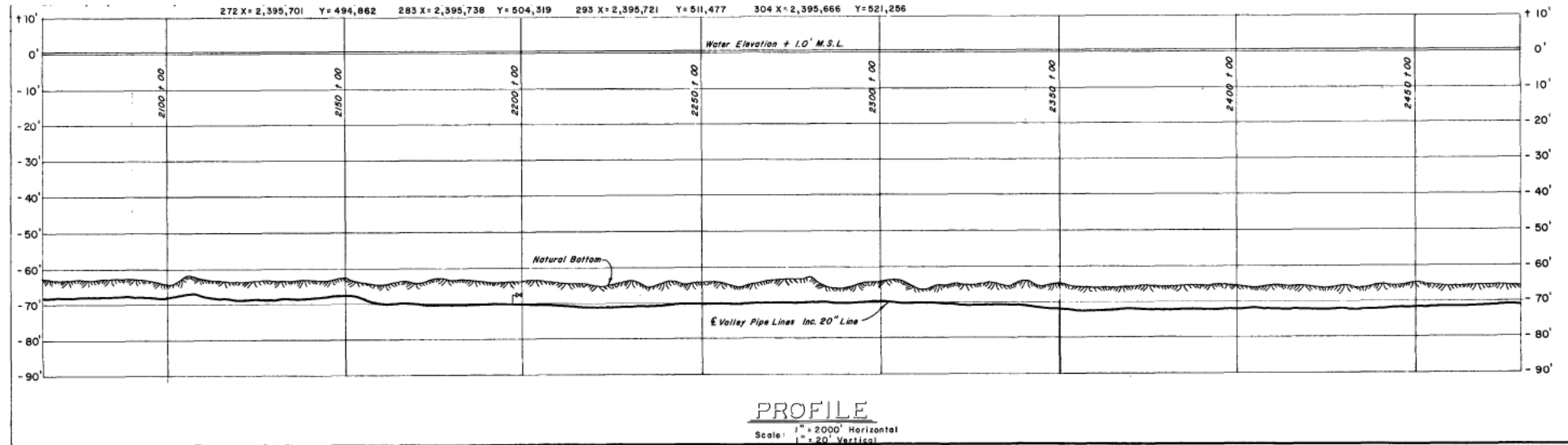
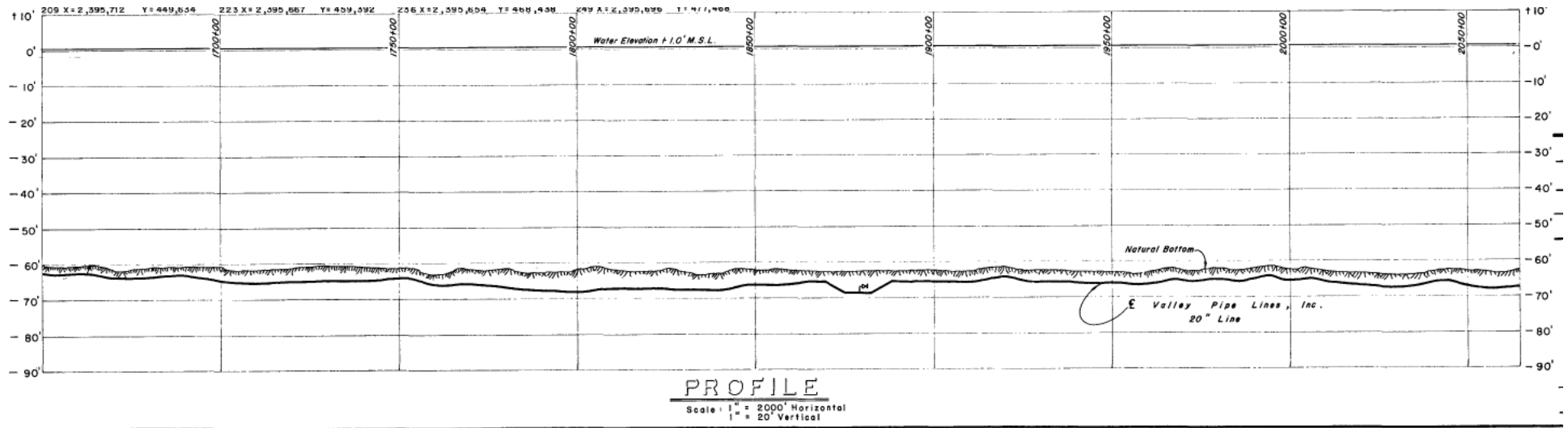

Date: 6/06/2023

**Legend**

Proposed Pipe to be Decommissioned in Place

Total length of pipeline to be decommissioned is 71.1 miles.

Elevations at South Padre Island CG Station 8779748

Mean High Water (MHW)- 1.31'

Mean Low Water (MLW)- 0.14'

Mean Lower-Low Water (MLLW)- 0.00'

This drawing is a generalized depiction of the original data. (Source: 1601 Engineering Drawings: HC-1601-10-V, from client).

VALLEY PIPE LINES, INC.
PROJECT PROFILE - SHEET 3 of 5
Proposed Permit Modification
Decommissioning in Place
of 20" Pipeline and 10" Laterals
Padre Island
Kenedy, Kleberg & Wilacy
Counties, Texas

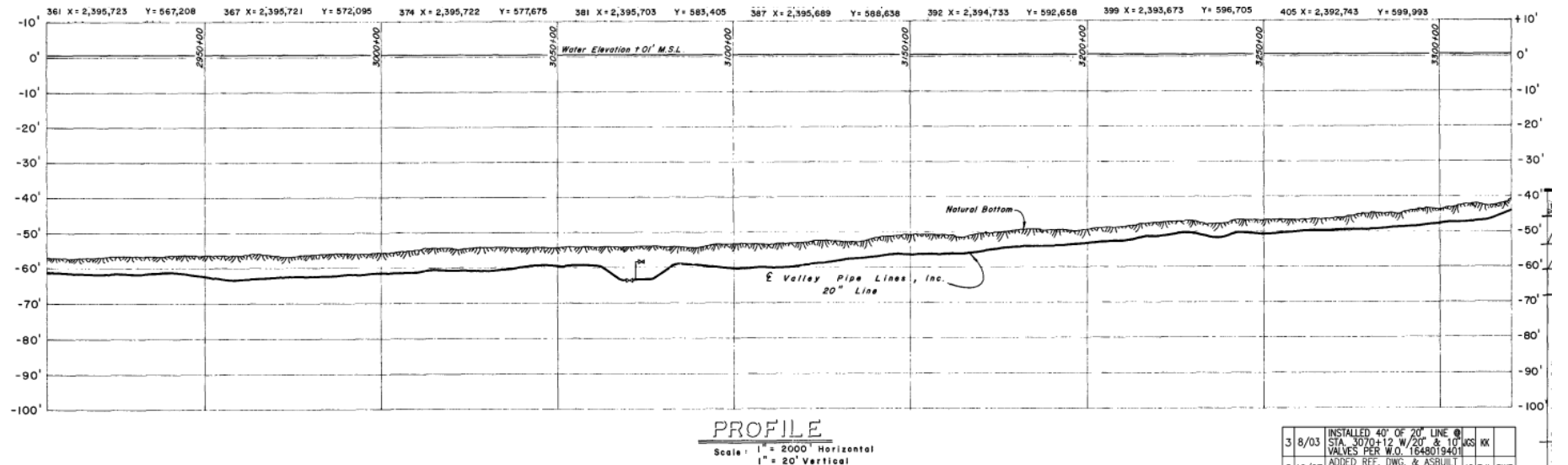
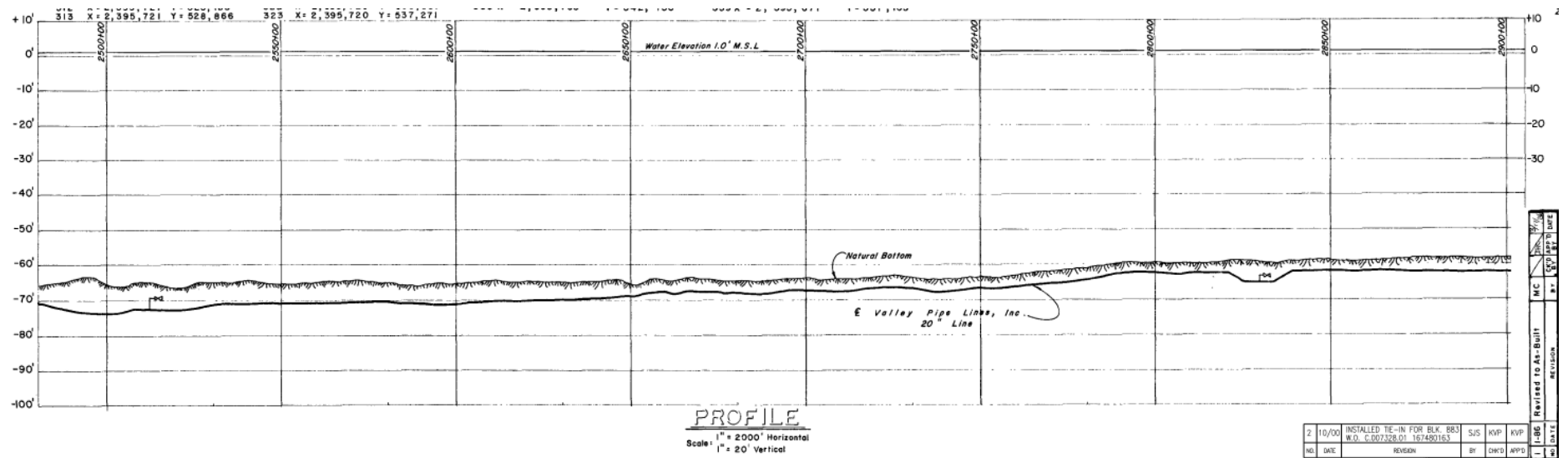

Date: 6/06/2023

**Legend**

— Proposed Pipe to be Decommissioned in Place

Total length of pipeline to be decommissioned is 71.1 miles.

Elevations at South Padre Island CG Station 8779748

Mean High Water (MHW)- 1.31'

Mean Low Water (MLW)- 0.14'

Mean Lower-Low Water (MLLW)- 0.00'

This drawing is a generalized depiction of the original data. (Source: 1601 Engineering Drawings: HC-1601-10-V, from client).

VALLEY PIPE LINES, INC.

PROJECT PROFILE - SHEET 4 of 5

**Proposed Permit Modification
Decommissioning in Place
of 20" Pipeline and 10" Laterals
Padre Island
Kenedy, Kleberg & Wilacy
Counties, Texas**

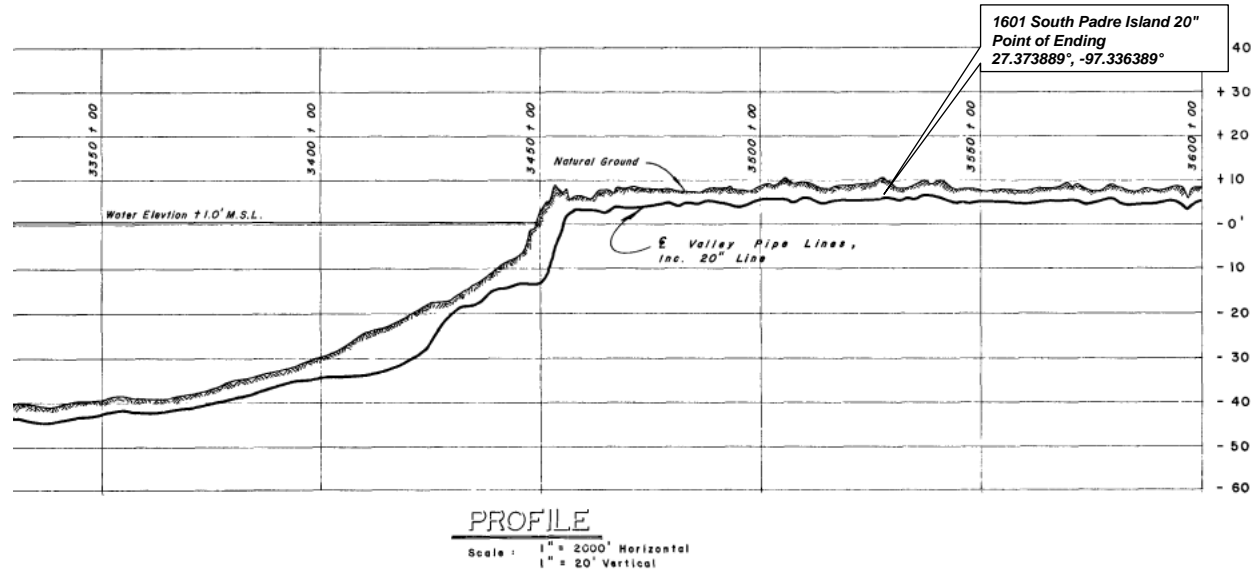

Date: 6/06/2023

**Legend**

— Proposed Pipe to be Decommissioned in Place

Total length of pipeline to be decommissioned is 71.1 miles.

Elevations at South Padre Island CG Station 8779748

Mean High Water (MHW)- 1.31'

Mean Low Water (MLW)- 0.14'

Mean Lower-Low Water (MLLW)- 0.00'

(Source: 1601 Engineering Drawings: HC-1601-10-V, from client). This drawing is a generalized depiction of the original data.

VALLEY PIPE LINES, INC.
PROJECT PROFILE - SHEET 5 of 5
Proposed Permit Modification
Decommissioning in Place
of 20" Pipeline and 10" Laterals
Padre Island
Kenedy, Kleberg & Wilacy
Counties, Texas



Date: 6/02/2023

PLAN AND PROFILE TYPICAL

NOT TO SCALE

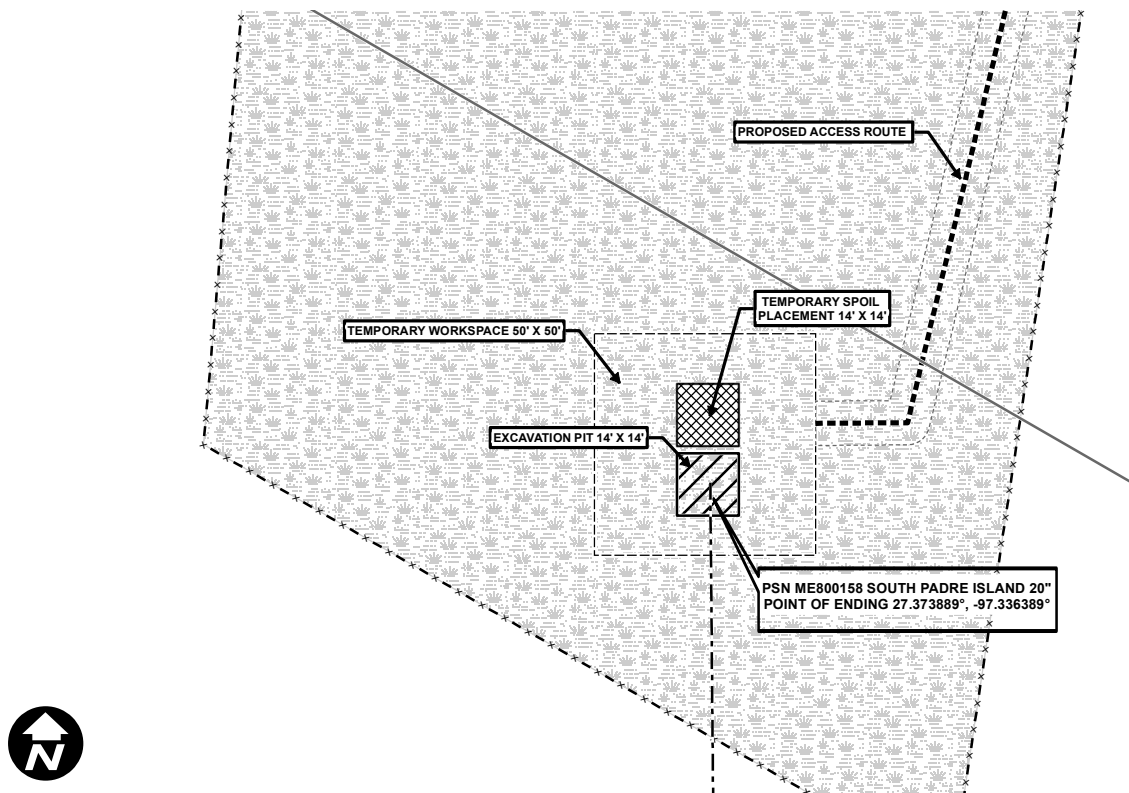
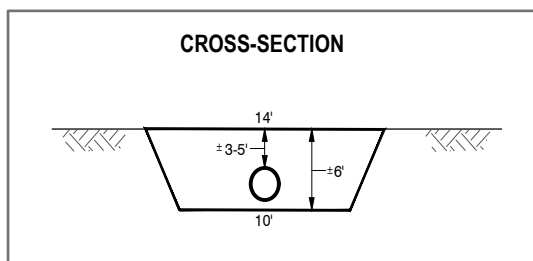
PLAN TYPICALPROFILE TYPICAL

LOOKING EASTWARD

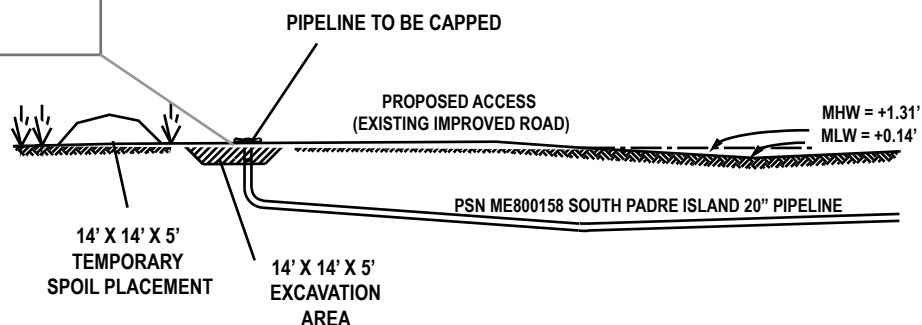
**NOTES:**

APPROXIMATELY 44 CUBIC YARDS OF SPOIL TO BE TEMPORARILY DISPLACED DURING EXCAVATION AND USED AS BACKFILL.

APPROXIMATELY 0.06 ACRES TOTAL ACRES TEMPORARILY IMPACTED FOR PROPOSED ACTIVITIES.

FOR PERMITTING PURPOSES ONLY. NOT TO BE USED FOR ENGINEERING DRAWINGS OR PLANNING.

VALLEY PIPE LINES, INC.

PLAN AND PROFILE TYPICAL

**Proposed Permit Modification
Decommissioning in Place
of 20" Pipeline and 10" Laterals
Padre Island
Kenedy, Kleberg & Willacy
Counties, Texas**



REV. 1

Date: 6/2/2023